

TAH

Eye Bolt Type Single Filter Cartridge Housing

Design P.	150psi
Design T.	100
Max Operating P.	150psi
Operating T.	75

Features

1. Easy installation with single filter cartridge housing.
2. Available with swing bolt closure for faster cartridge change-outs.
3. One well design pedestal is available with both DOE and SOE cartridge specification.



Applications

Chemicals	RO Pre-filtration process
Petrochemical	Water filtration
Beverage Industry	Pharmaceutical
Liquor manufacture	Experiment Process
Food industry	Gas Filter
Electroplating Industry	Sewage treatment
High temperature manufacturing processes	Electronic Industry



TAH Ordering Guide

TAH	1	4	F	1	PF	E	EA
Model	Length	Material	Adapters	Connection Size	Connection Type	O-ring	Outside / Inside Finishing
TAH	1-10" 2-20" 3-30"	4-304 6-316 6L-316L	F-DOE 5-222 7-226	21-1/2" 43-3/4" 1-1" 121-1-1/2" 2-2"	150P-ANSI 10K-JIS PN10-DIN C-CLAMP PF-PTF NF-NPTF PM-PTM NM-NPTM	E-EPDM N-NBR V-VITON S-Silicon	A-Acid-pickling E-Electropolishing P-Polishing

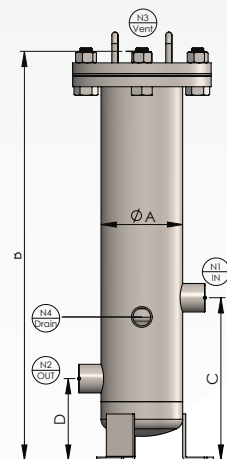
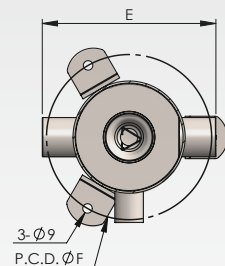

TAH Specifications

Model	Length of Cartridge	A m/m	B m/m	C m/m	D m/m	E m/m	F (PCD) m/m	M3/Hr	GPM	Weight
TAH1	10"	Ø106	536	210	105	165	Ø156	1	5	12.5kg
TAH2	20"	Ø106	786	210	105	165	Ø156	2	10	16kg
TAH3	30"	Ø106	1036	210	105	165	Ø156	3	15	19.5kg